

A-A

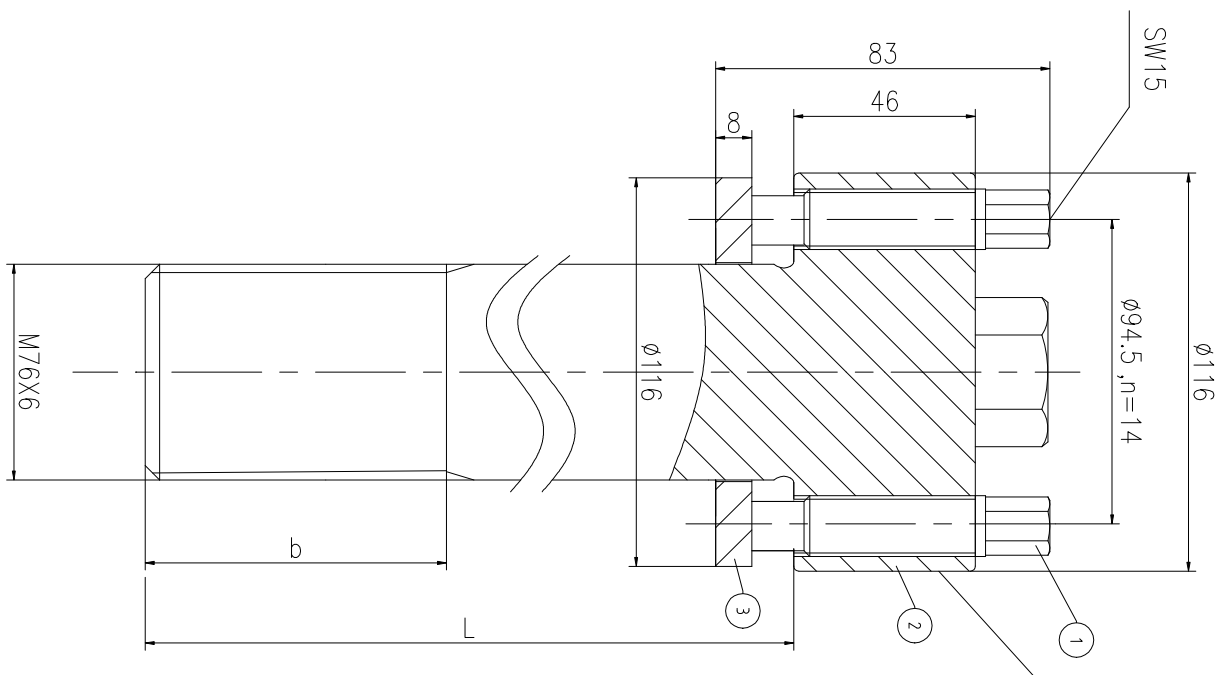

Logo
 PSN:model
 NO: drawing number
 NOM torque:**
 NOM preload:**
 MAX:max preload

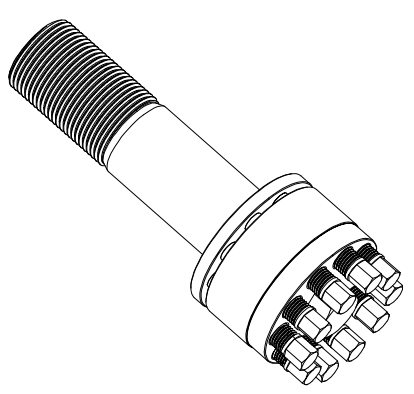
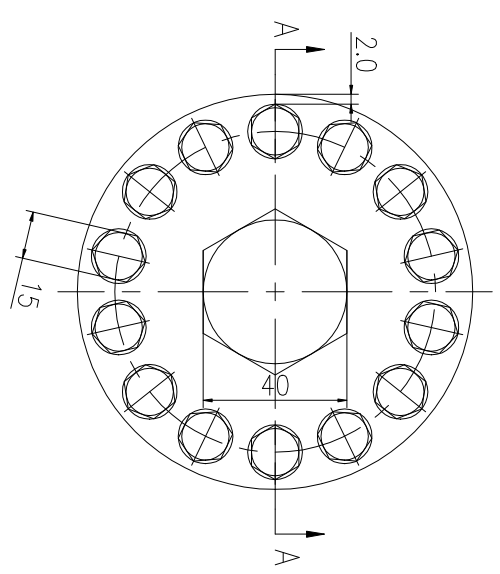

PARTS LIST

PART	DWG NO.	QTY	DESCRIPTION	MATERIAL	WEIGHT(kg)
1	BBS17.516751	14	Bolt 11/16-16UN-75	CNMMo	0.14 / pcs
2	BS76671H-1	1	S-BOLT M76X6	CNMMo	/
3	BS76671H-3	1	Gasket 76.5X116X8	CNMMo	0.37

During on-site installation, please adjust the torque in conjunction with the bolt stretching distance. Without our authorization, the drawings shall not be shared with any third party, and we reserve the right to pursue legal liability against those who disclose the drawings to external parties.

上海康普曼传动机械有限公司
 KPM Power Transmission (Shanghai) Co.,Ltd
 +86 021-61301856

DESIGNED: DATE: 2025.12.02
 REVIEWED: DATE: 2025.12.02
 DRAWN: DATE: 2025.12.02

BSH-76X6

DWG NO.: BS76671H
 SHEET: 1/1
 STATE: PRELIMINARY APPROVED

REV	DESCRIPTION	DWG CHECK	APPR BY	APPR DATE

The dimensions at B and L positions are tailored to the customer's specific requests