

REV	DESCRIPTION	DWG CHECK	APPR BY	APPR DATE

REVISION HISTORY

Logo
 PSN:model
 NO:drawing number
 NOM torque:**
 NOM preload:**
 MAX:max preload

A-A

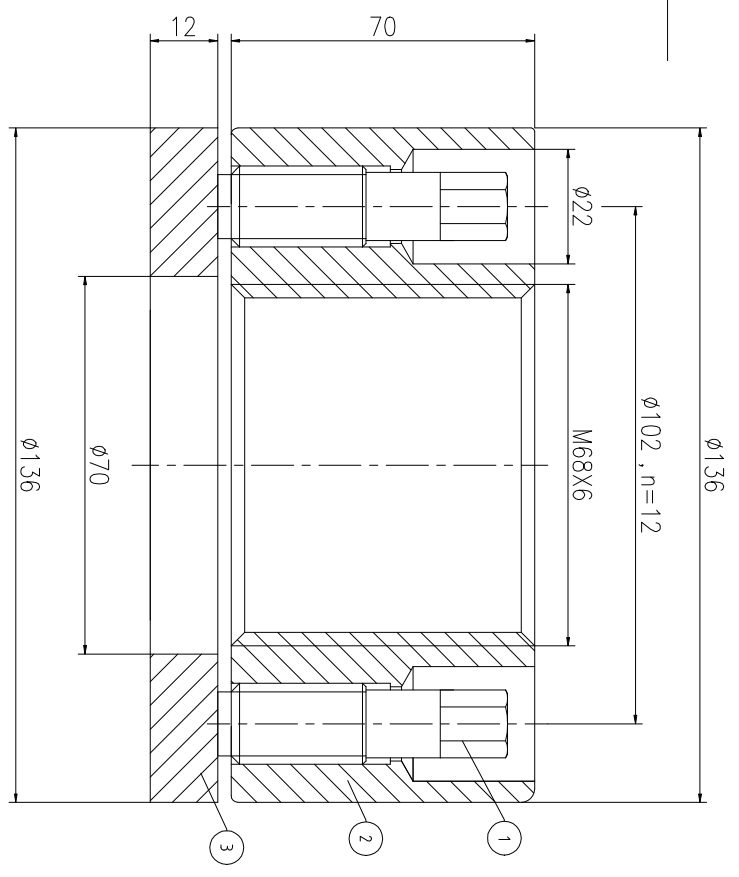
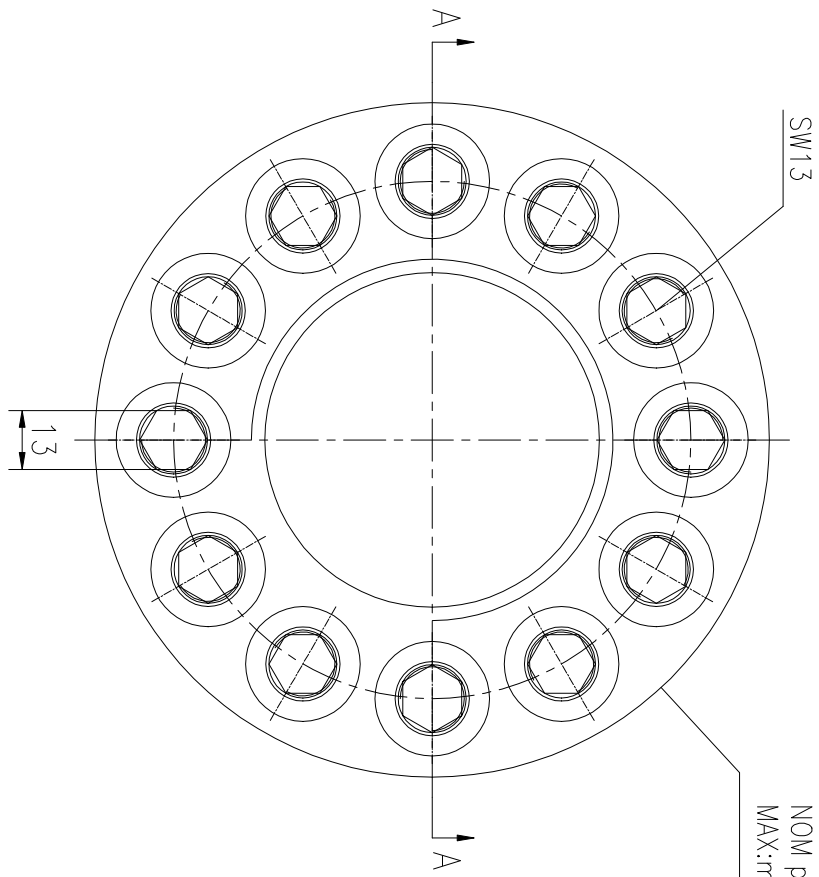

PARTS LIST

PART	DWG NO.	QTY	DESCRIPTION	MATERIAL	WEIGHT(kg)
1	BCHH17.516641	12	Bolt 11/16-16UN-64	CNMMo	0.10 /pcs
2	CHH68661M-1	1	Nut M68X6	CNMMo	4.81
3	CHH68661M-3	1	Gasket 70X136X12	CNMMo	1.01

During on-site installation, please adjust the torque in conjunction with the bolt stretching distance. Without our authorization, the drawings shall not be shared with any third party, and we reserve the right to pursue legal liability against those who disclose the drawings to external parties.

上海康普曼传动机械有限公司
 KPM Power Transmission (Shanghai) Co.,Ltd

DESIGNED: DATE: 2025.12.01
 REVIEWED: DATE: 2025.12.01
 DRAWN: DATE: 2025.12.01

CHHM-68X6
 DWG NO: CHH68661M

Lieng.Guo@kpmdrive.com.cn
 +86 021-61301856

WEIGHT: 6.99 kg
 STATE: PRELIMINARY APPROVED
 SHEET: 1:1

NOM TORQUE	250 NM
NOM PRELOAD	1370 KN
MAX PRELOAD CAPACITY	1825 KN
LUBRICANT	G-N PLUS
TEMPERATURE RATING	-25 C~250 C

