

REV	DESCRIPTION	DWG CHECK	APPR BY	APPR DATE

REVISION HISTORY

Logo
 PSN:model
 NO: drawing number
 NOM torque:**
 NOM preload:**
 MAX:max preload

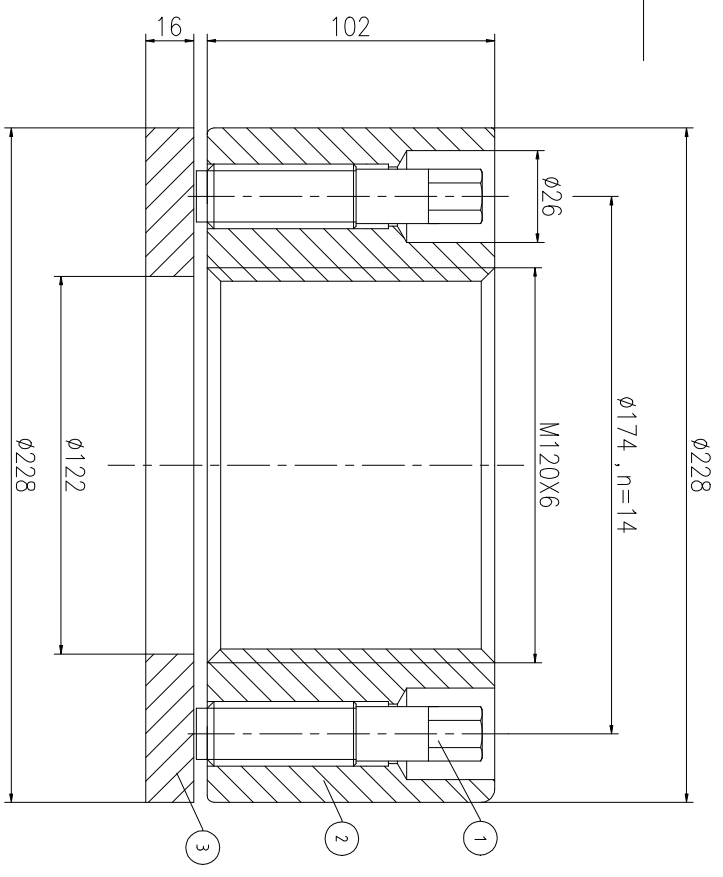
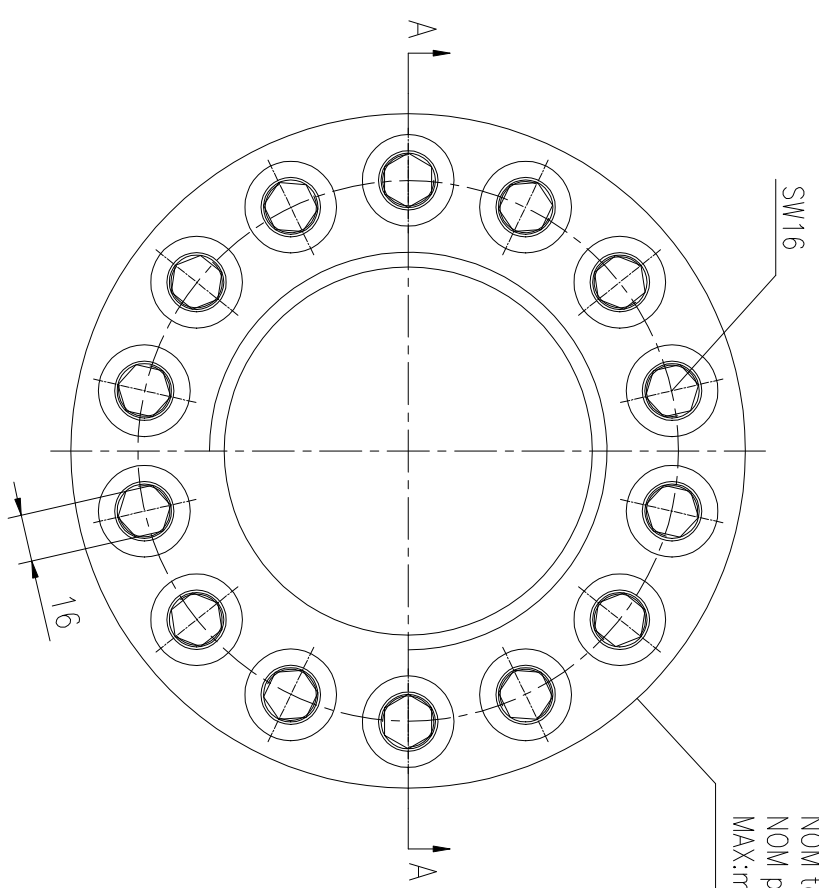

A-A

PARTS LIST

PART	DWG NO.	QTY	DESCRIPTION	MATERIAL	WEIGHT(kg)
1	BCHH20.6161011	14	Bolt 13/16-16UN-101	CNMMo	0.22 / pcs
2	CHH120671M-1	1	Nut M120X6	CNMMo	20.50
3	CHH120671M-3	1	Gasket 122X228X16	CNMMo	3.66

During on-site installation, please adjust the torque in conjunction with the bolt stretching distance. Without our authorization, the drawings shall not be shared with any third party, and we reserve the right to pursue legal liability against those who disclose the drawings to external parties.

上海康普曼传动机械有限公司
 KPM Power Transmission (Shanghai) Co.,Ltd
 +86 021-61301856
 Liang.Guo@kpmdrive.com.cn

NOM TORQUE	498 NM
NOM PRELOAD	2690 KN
MAX PRELOAD CAPACITY	3575 KN
LUBRICANT	G-N PLUS
TEMPERATURE RATING	-25 C~250 C

DESIGNED:	DATE:	2025.12.01	CHHM-120X6
REVIEWED:	DATE:	2025.12.01	
DRAWN:	DATE:		DWG NO.: CHH120671M
			SHEET: 1:1
			WEIGHT: 27.28 kg
			STATE: PRELIMINARY APPROVED

