

REV	DESCRIPTION	DWG CHECK	APPR BY	APPR DATE

REVISION HISTORY

Logo
 PSN:model
 NO:drawing number
 NOM torque:**
 NOM preload:**
 MAX:max preload

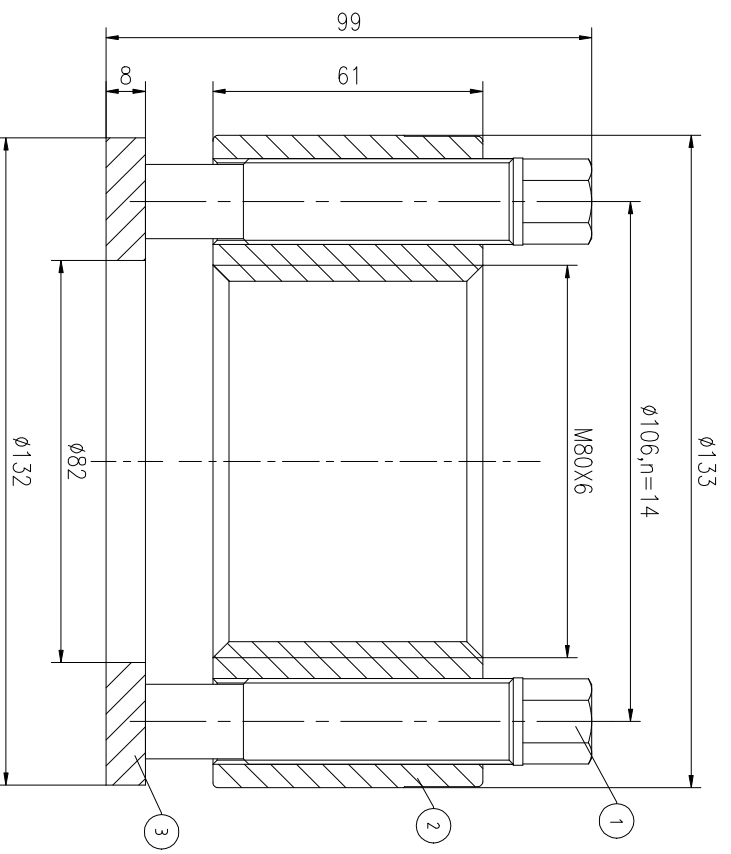
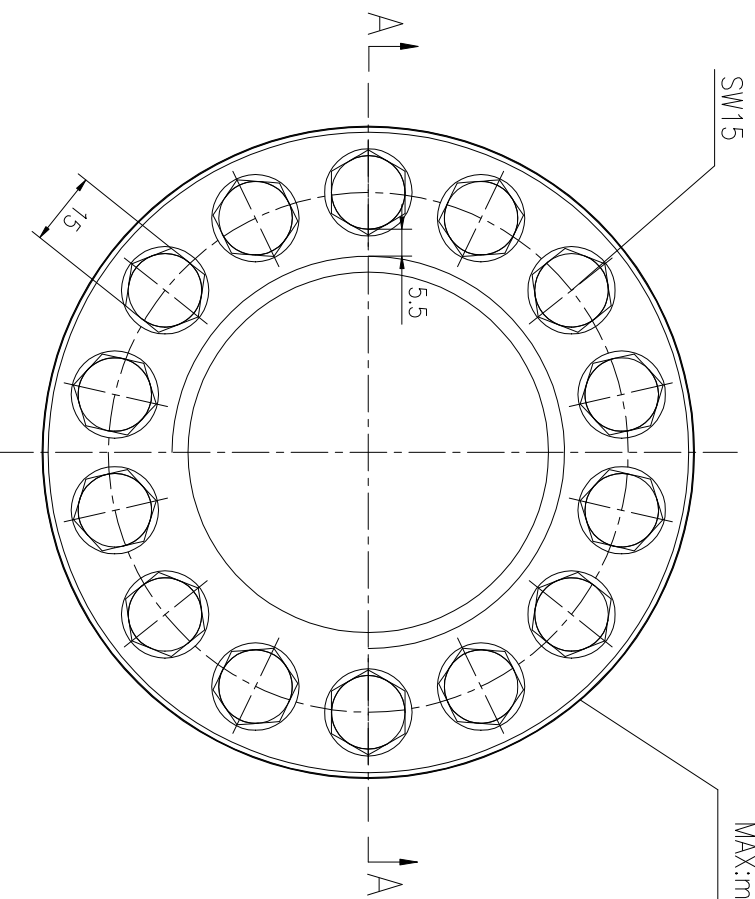

PARTS LIST

PART	DWG NO.	QTY	DESCRIPTION	MATERIAL	WEIGHT(kg)
1	BAS17.516911	14	Bolt 11/16-16UN	CNMMo	0.17pcs
2	AS80671H-1	1	Nut M80X6	CNMMo	2.65
3	AS80671H-3	1	Gasket Ø82XØ132X8	CNMMo	0.52

During on-site installation, please adjust the torque in conjunction with the bolt stretching distance. Without our authorization, the drawings shall not be shared with any third party, and we reserve the right to pursue legal liability against those who disclose the drawings to external parties.

上海康普曼传动机械有限公司 +86 021-61301856
 KPM Power Transmission (Shanghai) Co.,Ltd Liang.Guo@kpmdrive.com.cn

NOM TORQUE	352NM	DESIGNED:	DATE:	2025.10.03	DWG NO.:	AS80671H	SHEET:	1:1
NOM PRELOAD	2260KN	REVIEWED:	DATE:	2025.10.03	DWG NO.:	AS80671H	SHEET:	1:1
MAX PRELOAD CAPACITY	2950KN	TEMPERATURE RATING	-25 C~250 C °					
LUBRICANT	G-N PLUS	PRELIMINARY APPROVED						

