

REV	DESCRIPTION	DWG CHECK	APPR BY	APPR DATE

REVISION HISTORY

Logo
 PSN:model
 NO:drawing number
 NOM torque:**
 NOM preload:**
 MAX:max preload

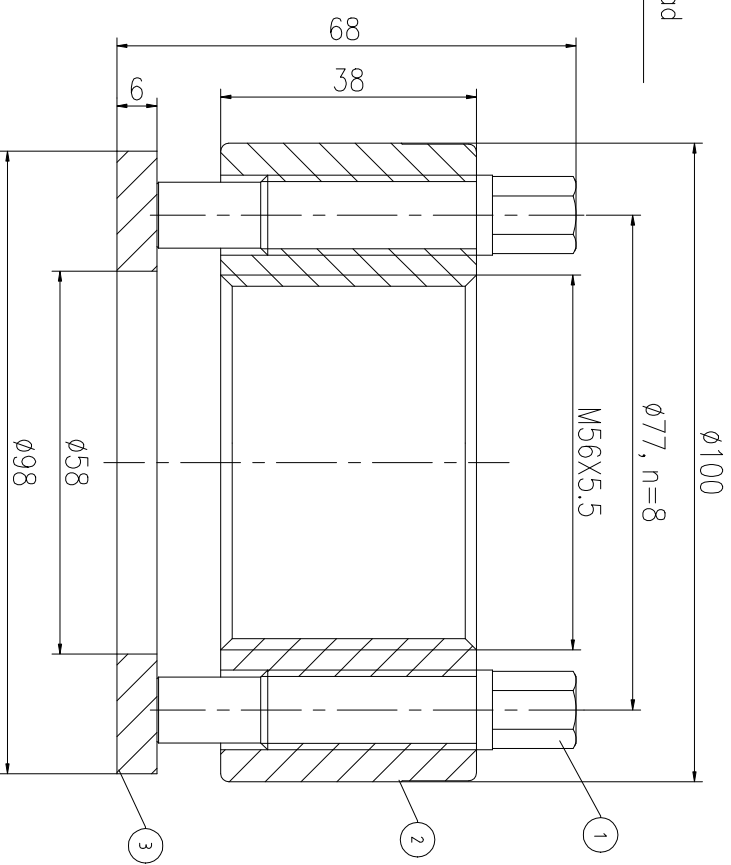
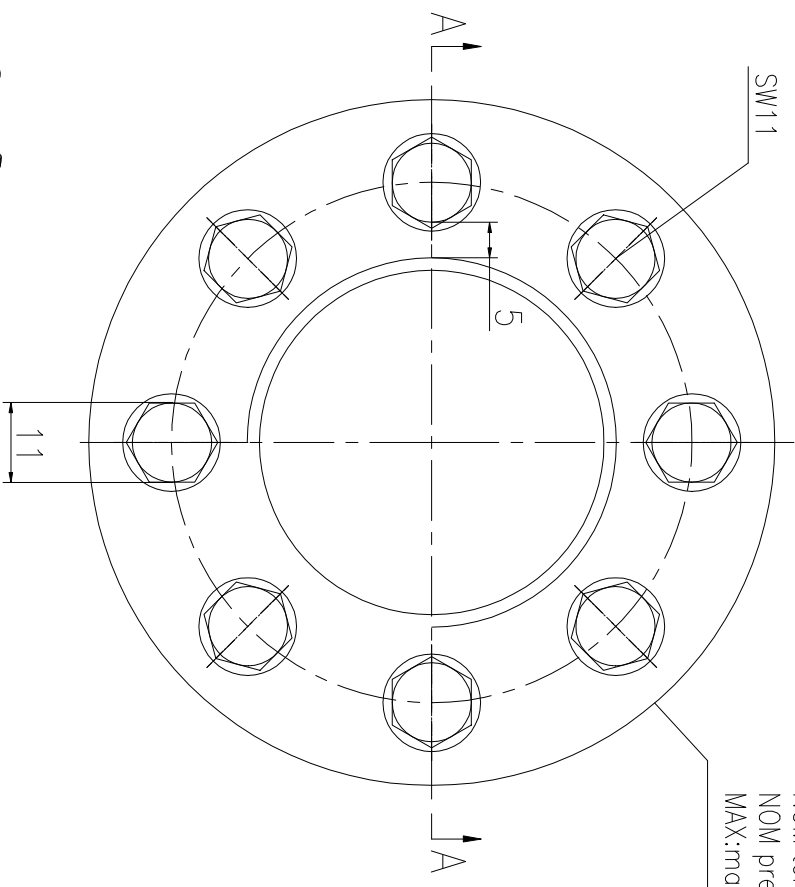

A-A

PART	DWG NO.	QTY	DESCRIPTION	MATERIAL	WEIGHT(kg)
1	BAS12.720623	8	Bolt 1/2-20UNF	CNMMo	0.06/pos
2	ASS65.541M-1	1	Nut M56X5.5	CNMMo	1.37
3	ASS65.541M-3	1	Gasket 58X98X6	CNMMo	0.23

During on-site installation, please adjust the torque in conjunction with the bolt stretching distance. Without our authorization, the drawings shall not be shared with any third party, and we reserve the right to pursue legal liability against those who disclose the drawings to external parties.

PARTS LIST

上海康普曼传动机械有限公司
 KPM Power Transmission (Shanghai) Co.,Ltd
 +86 021-61301856

DESIGNED: DATE: 2025.11.06
 REVIEWED: DATE: 2025.11.06
 DRAWN: DATE: 2025.11.06

Lieng.Guo@kpmdrive.com.cn
 ASM-56X5.5
 DWG NO.: ASS65.541M

WEIGHT: 2.1kg
 STATE: PRELIMINARY APPROVED
 SHEET: 1:1

NOM TORQUE	141NM
NOM PRELOAD	700KN
MAX PRELOAD CAPACITY	935KN
LUBRICANT	G-N PLUS
TEMPERATURE RATING	-25 C~250 C *

